

PORT MELBOURNE 229 Bridge Street

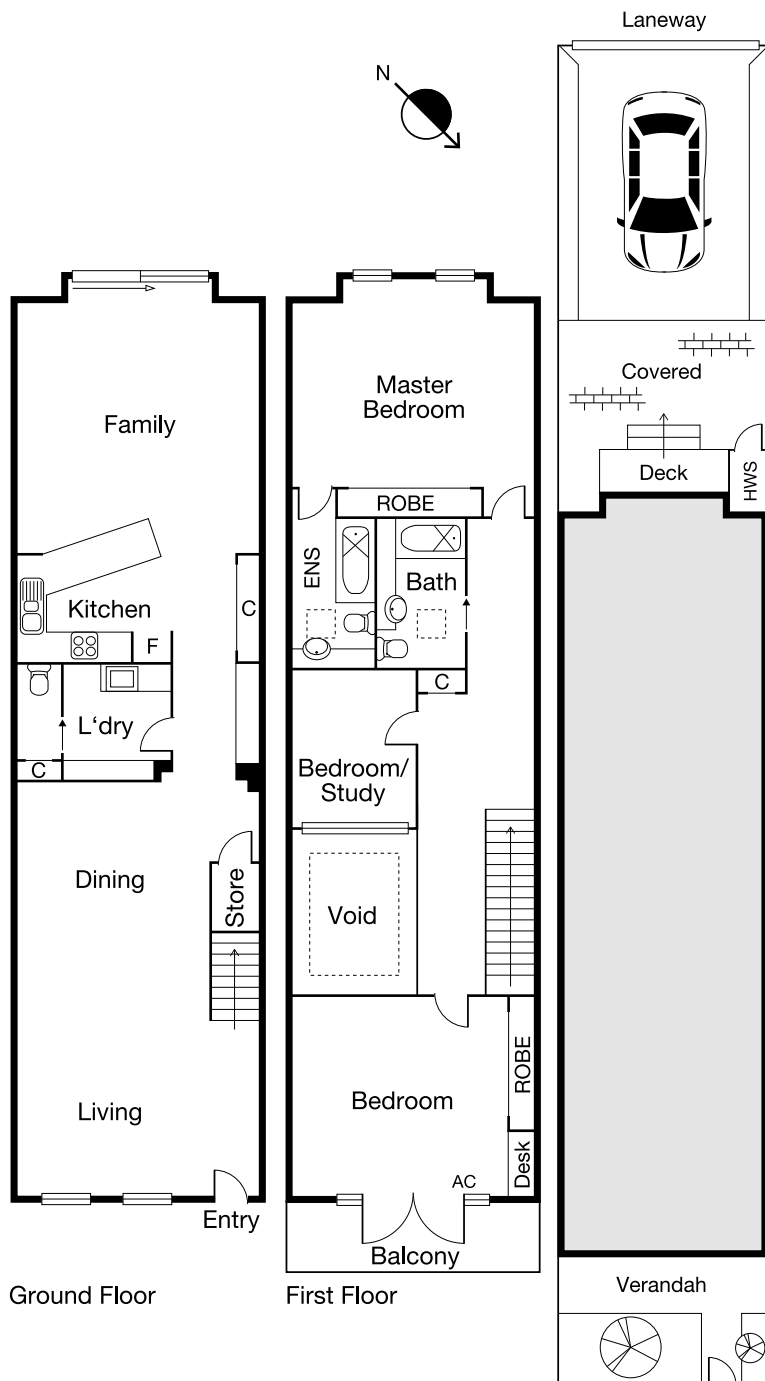

**CAYZER**

## WOODRUFF TERRACE — CIRCA 1989



- Contemporary design, two storey townhouse superbly presented
- Excellent off-street parking via remote roller door
- Land size approximately 161 m<sup>2</sup>

Featuring: Downstairs — entry, spacious light-filled living room with polished timber floors, modern kitchen and delightful family room. Separate laundry. Upstairs — Excellent size master bedroom, ensuite bathroom and built-in robes, second double bedroom, built-in robes, with double doors that open onto north facing balcony offering city skyline views. Central main bathroom, and third bedroom/study, central heating and ample storage.

Truly a great opportunity for a home buyer/investor wishing to value add to your own taste without the hefty price tag.

🏠 3 🚿 2 🚗 2

**Auction** Saturday 1 June at 12pm

**Inspection** As advertised or by appointment

**Contact** Andrew Turner 0408 211 281  
 Jordan Gravestein 0448 250 193  
 Jason De Stefano 0413 292 666

**Mel Ref** 57 B1



Interactive Floorplan

# CAYZER

Albert Park 330 Montague Street 03 9699 5999  
 Port Melbourne 370 Bay Street 03 9646 0812

[cayzer.com.au](http://cayzer.com.au)